

LAND USE RESTRICTION ZONING LIMITS. DISTANCE FROM AIRPORT PROPERTY: 2 MILES IN APPROACHES 1 MILE TYPICAL

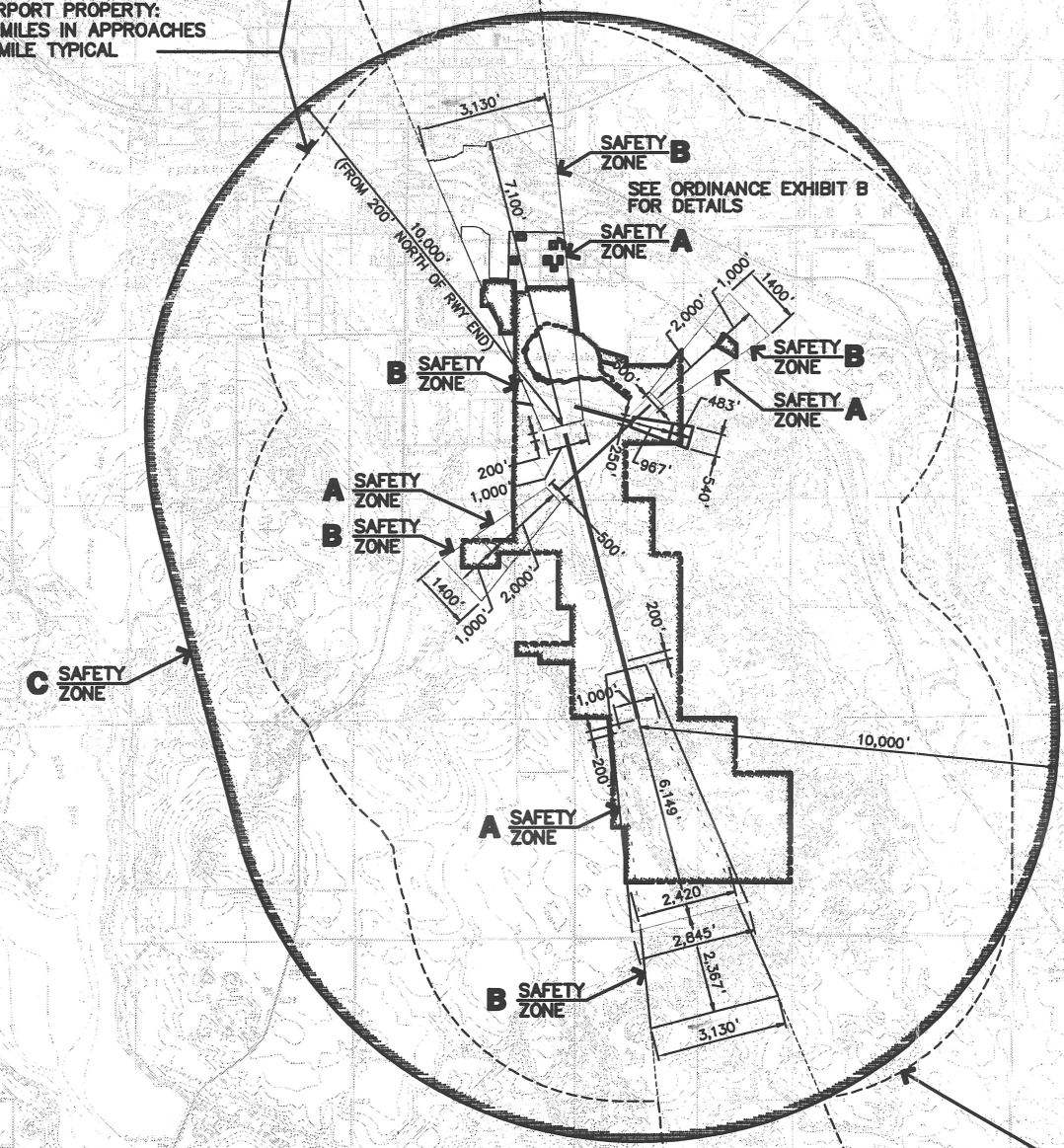

LAND USE RESTRICTION ZONING LIMITS. DISTANCE FROM AIRPORT PROPERTY: 2 MILES IN APPROACHES 1 MILE TYPICAL

| RUNWAY | INNER WIDTH* | LENGTH | OUTER WIDTH |
|--------|--------------|---------|-------------|
| 16 | 1,000' | 50,000' | 16,000' |
| 34 | 1,000' | 50,000' | 16,000' |
| 5 | 500' | 5,000' | 2,000' |
| 23 | 500' | 5,000' | 2,000' |
| 10 | 250' | 5,000' | 1,250' |
| 28 | 250' | 5,000' | 1,250' |

* DIMENSIONS GIVEN ARE THE SAME FOR THE PRIMARY SURFACE WIDTH.

NOTES:

1. ALL ELEVATIONS ARE IN FEET ABOVE MEAN SEA LEVEL.
2. ESTABLISHED AIRPORT ELEVATION 1366 M.S.L.
3. IMAGINARY SURFACE DIMENSIONS SHOWN ARE THE MOST RESTRICTIVE OF APPLICABLE FAA AND MnDOT CRITERIA.
4. THE AERIAL CONTOURS ILLUSTRATE THE HEIGHT LIMITATIONS WITHIN EACH ZONE.
5. ZONING APPLIES TO AREAS UNDERLYING THE IMAGINARY SURFACE BOUNDARIES.
6. A SLOPE SUCH AS 40:1 EXPRESSES THE HORIZONTAL DISTANCE OF 40' TO THE VERTICAL DISTANCE OF 1'.
7. BASE MAP: USGS 7.5 MINUTE SERIES CURRENT: 1970

LEGEND

- RUNWAY
- ZONE BOUNDARY
- HEIGHT RESTRICTION ZONING LIMITS
- AERIAL CONTOURS
- AIRPORT PROPERTY

GRAND RAPIDS – ITASCA COUNTY AIRPORT
GRAND RAPIDS, MINNESOTA

AIRPORT ZONING PLAN
LAND USE ZONING MAP

GRAND RAPIDS-ITASCA CO. AIRPORT GRAND RAPIDS, MINNESOTA
TKDA
 ENGINEERS-ARCHITECTS-PLANNERS